

AXS RC/RCB series

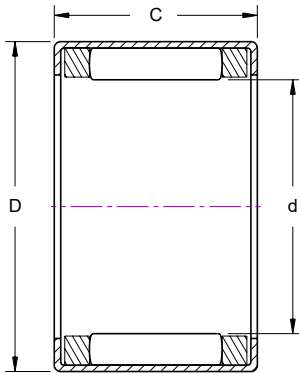

RC

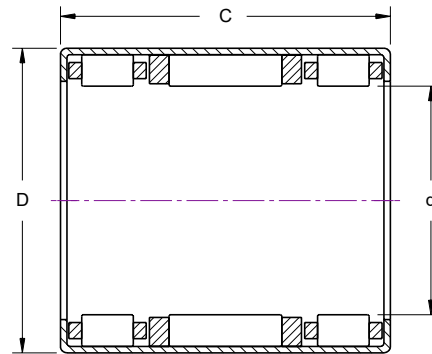

RCB

| Bearing Number | Dimensions (inch) | | | Torque Rating lbf-in | Min. OD of Steel Housing for Rated Torque | Suitable Needle Roller | Overrun Limiting Speed Rating for Rotating Shaft | Mounting | | | |
|----------------|-------------------|-------|-------|-------------------------|---|------------------------|--|----------------|--------|--------------|--------|
| | d | D | C | | | | | Shaft Diameter | | Housing Bore | |
| | | | | Max. | Min. | Max. | Min. | | | | |
| RC-061008 | 0.375 | 0.625 | 0.500 | 42.7 | 0.88 | BH-68 | 18000 | 0.3750 | 0.3745 | 0.6255 | 0.6245 |
| RC-081208 | 0.500 | 0.750 | 0.500 | 69.9 | 1.10 | BH-87 | 17000 | 0.5000 | 0.4995 | 0.7505 | 0.7495 |
| RC-101410 | 0.625 | 0.875 | 0.625 | 136.3 | 1.20 | BH-1010 | 14000 | 0.6250 | 0.6245 | 0.8755 | 0.8745 |
| RC-121610 | 0.750 | 1.000 | 0.625 | 185.0 | 1.40 | B-126 | 12000 | 0.7500 | 0.7495 | 1.0005 | 0.9995 |
| RC-162110 | 1.000 | 1.313 | 0.625 | 398.3 | 1.90 | BH-1612 | 8700 | 1.0000 | 0.9995 | 1.3130 | 1.3120 |

| Bearing Number | Dimensions (inch) | | | Torque Rating lbf-in | Min. OD of Steel Housing for Rated Torque | Load Rating | | Overrun Limiting Speed Rating for Rotating Shaft | Mounting | | | |
|----------------|-------------------|--------|--------|-------------------------|---|-------------|--------|--|----------------|--------|--------------|--------|
| | d | D | C | | | Dynamic | Static | | Shaft Diameter | | Housing Bore | |
| | | | | Cr | Cor | Max. | Min. | Max. | Min. | | | |
| RCB-061014 | 0.375 | 0.6250 | 0.8750 | 42.7 | 0.88 | 1350 | 1100 | 18000 | 0.3750 | 0.3745 | 0.6255 | 0.6245 |
| RCB-081214 | 0.500 | 0.7500 | 0.8750 | 69.9 | 1.10 | 1600 | 1460 | 17000 | 0.5000 | 0.4995 | 0.7505 | 0.7495 |
| RCB-101416 | 0.625 | 0.8750 | 1.0000 | 136.3 | 1.20 | 1810 | 1830 | 14000 | 0.6250 | 0.6245 | 0.8755 | 0.8745 |
| RCB-121616 | 0.750 | 1.0000 | 1.0000 | 185.0 | 1.40 | 2000 | 2200 | 12000 | 0.7500 | 0.7495 | 1.0005 | 0.9995 |
| RCB-162117 | 1.000 | 1.3130 | 1.0630 | 398.3 | 1.90 | 3460 | 3960 | 8700 | 1.0000 | 0.9995 | 1.3130 | 1.3120 |